



TK International
020 7794 8700
www.t-k.co.uk

Residential Sales
Residential Lettings
Property Management

Sales Office:
9 Heath Street
Hampstead
London NW3 6TP
E: sales@t-k.co.uk

Lettings Office:
16-18 Heath Street
Hampstead
London NW3 6TE
E: lettings@t-k.co.uk

 tk.international
 TK International
 TK International

Est.
1998



Fitzjohns Avenue London NW3

This exquisite two-bedroom apartment occupies the first floor of an elegant Victorian building. The spacious living room boasts lofty ceilings and hardwood flooring that seamlessly transitions into the kitchen.

Featuring two double bedrooms and two bathrooms, the property offers ample accommodation. An extensive and well maintained communal garden can also be accessed through the side gate. Situated on Fitzjohn's Avenue, it enjoys a prime location convenient for Hampstead Village, Swiss Cottage, and Finchley Road amenities, with excellent transport links via the Northern and Jubilee lines.

£3,250 Per Month

SOLE AGENT







Fitzjohn's Avenue, NW3

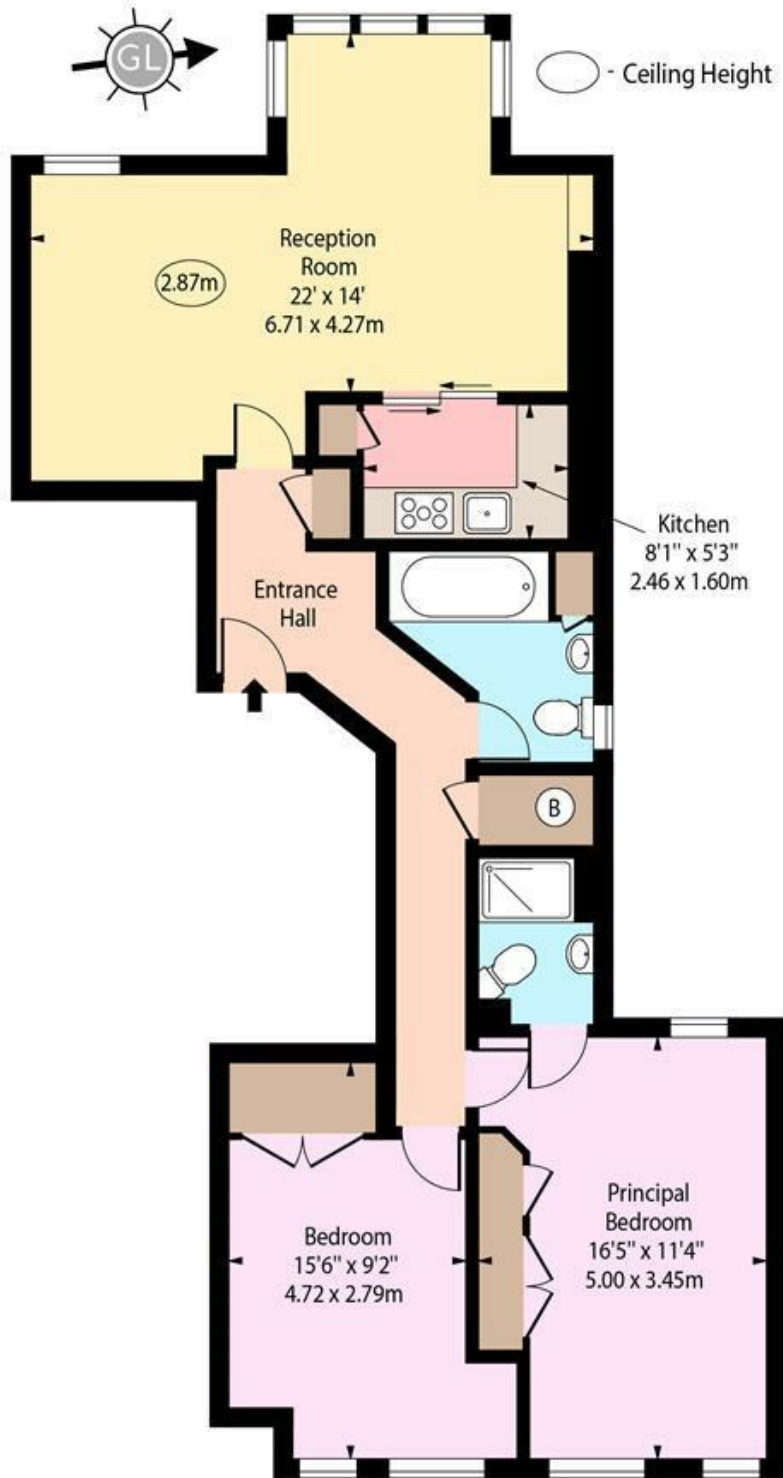

First Floor

Approx Gross Internal Area 858 Sq Ft - 79.81 Sq M

For Illustration Purposes Only - Not To Scale

www.goldlens.co.uk

Prepared for TK International

Ref. No. 023076E